

# OSi PLACE Map

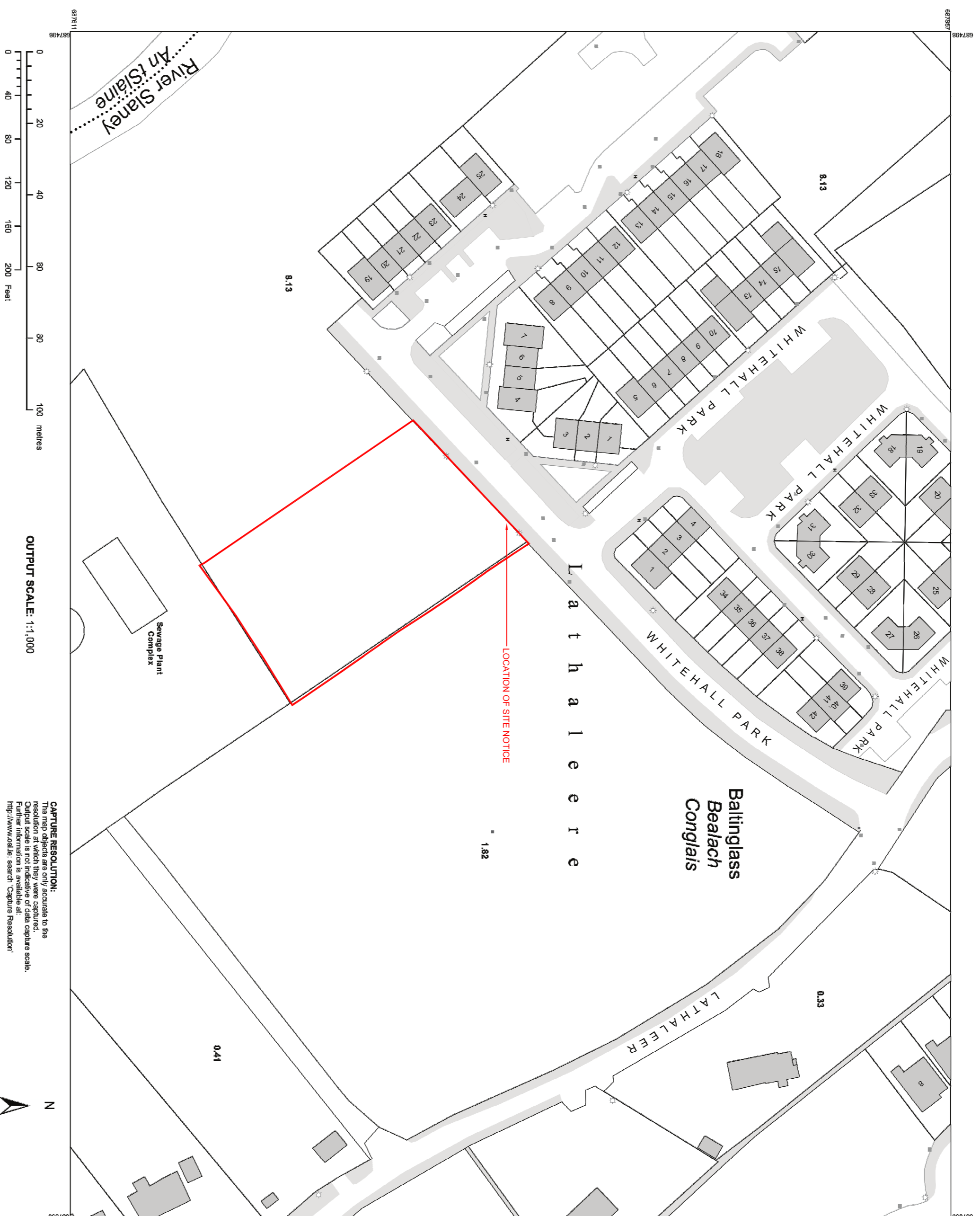

SITE BOUNDARY SHOWN IN RED



**CENTRE COORDINATES:**  
 TM: 57454357734  
**PUBLISHED:** 30/11/2022  
**ORDER NO.:** 80305517\_2  
**MAP SERIES:** 1:2500  
**MAP SHEETS:** 4127 D

**COMPILED AND PUBLISHED BY:**  
 Ordnance Survey Ireland,  
 Phoenix Park,  
 Dublin 8,  
 Ireland.

Unauthorized reproduction infringes Ordnance Survey Ireland copyright.  
 All rights reserved.  
 No part of this publication may be copied, reproduced or transmitted in any form or by any means, electronic or mechanical, including photocopying, recording, or by any information storage and retrieval system, without the prior written permission of the copyright owner.  
 The representation on this map of road, track or footpath boundaries is not intended to show legal property boundaries, nor do they show the exact location of physical features.

OSi Data provided by Ordnance Survey, 2022  
 Ordnance Survey Ireland, 2022  
 Ordnance Survey Ireland, 2022  
 www.ordnancesurvey.ie

**LEGEND:**  
 https://www.osi.ie/Help/Help.aspx?topic=Large%20Scale%20Legend

**CAPTURE RESOLUTION:**  
 This map is a vector capture of the OSi Data. The resolution of the data capture is 1:2500. The resolution of the data capture is 1:2500. The resolution of the data capture is 1:2500.  
 https://www.ordnancesurvey.ie/Help/Help.aspx?topic=Large%20Scale%20Legend



## SITE LOCATION MAP

NOTES:

REV	STA	NOTES	DATE	BY

DATE	BY

DATE	BY

DATE	BY

Job:	FIRE STATION REBURNISHMENT AND EXTENSION	Job No:	2211986
Site:	BALLYGLASS, CO. WICKLOW	Client:	WICKLOW COUNTY FIRE AND RESCUE SERVICE
Client:	WICKLOW COUNTY FIRE AND RESCUE SERVICE	Scale:	1:1000 @ A1
Drawing:	SITE LOCATION MAP	Revision:	

AD Design  
 Dublin 2  
 T: +353 1 2411 770  
 W: www.ad-design.ie  
 E: info@ad-design.ie

## APPLICATION UNDER PART 8 OF THE PLANNING & DEVELOPMENT REGULATIONS 2001 -2007